

# aiwa

# Active Speaker System (Powered Subwoofer)

## TS-W150

**U**

For assistance and information

**call toll free 1-800-BUY-AIWA**

(United States and Puerto Rico)

8B-YP3-913-01  
011220BMI-U

OPERATING INSTRUCTIONS

**En** (English)

MANUAL DE INSTRUCCIONES

**E** (Español)

MODE D'EMPLOI

**F** (Français)

**WARNING**

To reduce the risk of fire or electric shock, do not expose this appliance to rain or moisture.

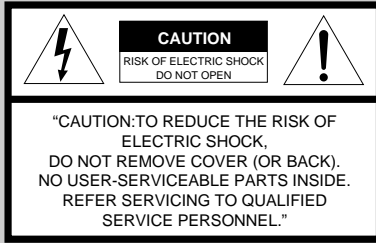
**Explanation of Graphical Symbols:**

The lightning flash with arrowhead symbol, within an equilateral triangle, is intended to alert the user to the presence of uninsulated "dangerous voltage" within the product's enclosure that may be of sufficient magnitude to constitute a risk of electric shock to persons.



The exclamation point within an equilateral triangle is intended to alert the user to the presence of important operating and maintenance (servicing) instructions in the literature accompanying the appliance.

**IMPORTANT SAFETY INSTRUCTIONS**

Read the Operating Instructions carefully and completely before operating the unit. Be sure to keep the Operating Instructions for future reference. All warnings and cautions in the Operating Instructions and on the unit should be strictly followed, as well as the safety suggestions below.

**Warning**

To prevent electric shock or injury, these safety instructions should be followed in the installation, use and servicing the unit.

**Installation**

**Attachments** - Do not use attachments not recommended by the unit manufacturer as they may result in the risk of fire, electric shock or injury to persons.

**Water and Moisture** - Do not use this unit near water - for example, near a bathtub, washbowl, kitchen sink, or laundry tub, in a wet basement, or near a swimming pool, and the like.

**Heat** - Do not use this unit near sources of heat, including heating vents, stoves, or other appliances that generate heat. It also should not be placed in temperatures less than 5°C (41°F) or greater than 35°C (95°F).

**Mounting surface** - Place the unit on a flat, even surface.

**Accessories** - Do not place this unit on an unstable cart, stand, tripod, bracket, or table. The unit may fall, causing serious injury to a child or an adult, and serious damage to the appliance. Use only with a cart, stand, tripod, bracket, or table recommended by the manufacturer, or sold with the unit. Any mounting of the appliance should follow the manufacturer's instructions, and should use a mounting accessory recommended by the manufacturer.

**Portable cart** - An appliance and cart combination should be moved with care. Quick stops, excessive force, and uneven surfaces may cause the appliance and cart combination to overturn.



**Ventilation** - The unit should be situated with adequate space around it so that proper heat ventilation is assured. Allow 10 cm clearance from the rear and the top of the unit, and 5 cm from the each side.

Slots and openings in the cabinet and the back or bottom are provided for ventilation, and to ensure reliable operation of the unit and to protect it from overheating, these openings must not be blocked or covered. The openings should never be blocked by placing the unit on a bed, sofa, rug or other similar surface. This unit should not be placed in a built-in installation such as a bookcase unless proper ventilation is provided.

**Object and Liquid Entry** - Never push objects of any kind into this unit through the cabinet slots as they may touch dangerous voltage points or short-circuit parts that could result in a fire or electric shock. Never spill liquid of any kind on the unit.

## Electric Power

**Power Sources** - This unit should be operated only from the type of power source indicated on the marking label. If you are not sure of the type of power supply to your home, consult your appliance dealer or local power company. To operate unit on battery power, or other sources, refer to the operating instructions.

**Grounding or Polarization** - This unit is provided with a polarized alternating-current line plug (a plug having one blade wider than the other). This plug will fit into the power outlet only one way. This is a safety feature. If you are unable to insert the plug fully into the outlet, try reversing the plug. If the plug should still fail to fit, contact your electrician to replace your obsolete outlet. Do not defeat the safety purpose of the polarized plug.

**Power-Cord Protection** - Power-supply cords should be routed so that they are not likely to be walked on or pinched by items placed upon or against them, paying particular attention to cords at plugs, convenience receptacles, and the point where they exit from the product.

**Overloading** - Do not overload wall outlets, extension cords, integral convenience receptacles as this can result in a risk of fire or electric shock.

## Lightning

For added protection for this unit receiver during a lightning storm, or when it is left unattended and unused for long periods of time, unplug it from the wall outlet and disconnect the antenna or cable system. This will prevent damage to the unit due to lightning and powerline surges.

## Maintenance

**Cleaning** - Unplug this unit from the wall outlet before cleaning. Do not use liquid cleaners or aerosol cleaners. Use a damp cloth for cleaning.

## Damage Requiring Service

Unplug this unit from the wall outlet and refer servicing to qualified service personnel under the following conditions:

- 1) When the power cord or plug is damaged.
- 2) If liquid has been spilled, or objects have fallen into the unit.
- 3) If the unit has been exposed to rain or water.
- 4) If the unit does not operate normally by following the operating instructions. Adjust only those controls that are covered by the operating instructions as improper adjustment of other controls may result in damage and will often require extensive work by a qualified technician to restore the unit to normal operation.
- 5) If the unit has been dropped or the cabinet has been damaged.
- 6) When the unit exhibits a distinct change in performance - this indicates a need for service.

Do not attempt to service this unit yourself as opening or removing covers may expose you to dangerous voltage or other hazards. Refer all servicing to qualified service personnel.

**Replacement Parts** - When replacement parts are required, be sure the service technician has used replacement parts specified by the manufacturer or having the same characteristics as the original part. Unauthorized substitutions may result in fire, electric shock or other hazards.

**Safety Check** - Upon the completion of any service or repairs to this unit, ask the service technician to perform safety checks to determine that the unit is in proper operating condition.

## TABLE OF CONTENTS

IMPORTANT SAFETY INSTRUCTIONS .....	2
PREPARATIONS .....	4
OPERATIONS .....	6
SPECIFICATIONS .....	7

## Supplied accessories

Connecting cord with RCA phono plugs (1)  
Speaker cords (2)

### OWNER'S RECORD

Record the model number and serial number of your set (found at the rear of your set) below. Refer to them when contacting your Aiwa dealer.

Model No. \_\_\_\_\_

Serial No. \_\_\_\_\_

# PREPARATIONS

## Positioning

Because low-frequency sound reproduced by the powered subwoofer is mostly non-directional, the listener will be unable to localize the bass source. Accordingly, the powered subwoofer provides maximum flexibility in terms of positioning. For the most effective low-frequency sound, the powered subwoofer should be placed on the floor close to a wall or in a corner of the room.

En

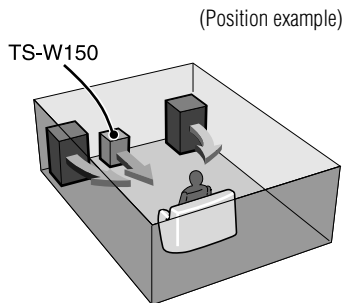

## Connection

There are two ways (A and B) to connect TS-W150 to equipment (stereo system, receiver or etc).  
If the equipment has an output jack for subwoofer, use A Connection.  
If not, use B Connection.

### Note

Do not connect TS-W150 to equipment in both A and B ways simultaneously.

## A Connection

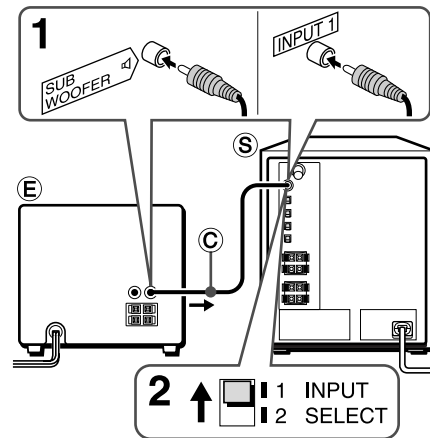

### Note

Do not plug in the AC power cords of both TS-W150 and the equipment to the AC power outlets before all other connections are made.

- 1 Connect the SUB WOOFER or SUPER WOOFER jack on the equipment to the INPUT 1 (FROM SUBWOOFER TERMINAL) jack on TS-W150 with the supplied connecting cord.
- 2 Set the INPUT SELECT switch to "1".
- 3 Connect the AC power cord to an AC outlet.

## B Connection

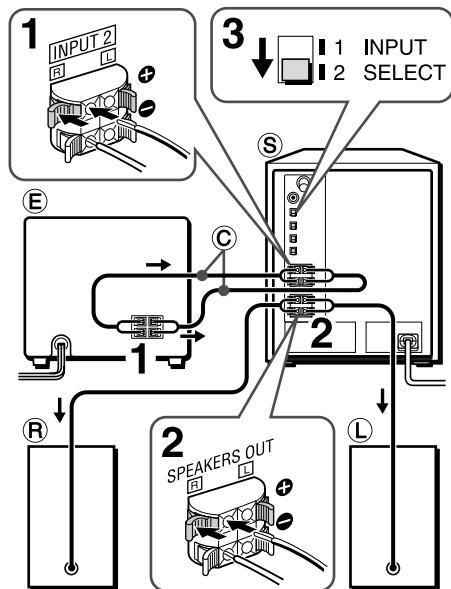

### Note

Do not plug in the AC power cords of both TS-W150 and the equipment to the AC power outlets before all other connections are made.

### Preparations

Turn off the power of the equipment and remove the speaker cords from the speaker terminals on the equipment.

- 1 Connect the speaker terminals on (E) the equipment to the INPUT 2 (FROM SPEAKERS OUT) terminals on (S) TS-W150 with (C) the supplied speaker cords.
  - Make sure the L and R and the ⊕ and ⊖ cords are connected correctly.
- 2 With the speaker cords removed from the equipment (see “Preparations” above), connect (R) the right and (L) left speakers to the SPEAKERS OUT terminals on (S) TS-W150.
- 3 Set the INPUT SELECT switch to “2”.
- 4 Connect the AC power cord to an AC outlet.

### Note

Use left/right speakers whose impedance corresponds with the value specified on the equipment.

## Dynamic Bass System

The TS-W150 adopts a Dynamic Bass System in which port (1), and air cavity (2) compose an acoustic bandpass filter in front of air cavity (1). By virtue of this structure, the bass reproduction limit is extended and sounds higher than middle range frequencies are reduced in the Dynamic Bass System. This makes it possible for the TS-W150 to reproduce powerful bass sound.

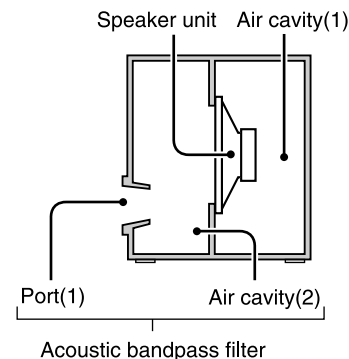

# OPERATIONS

En

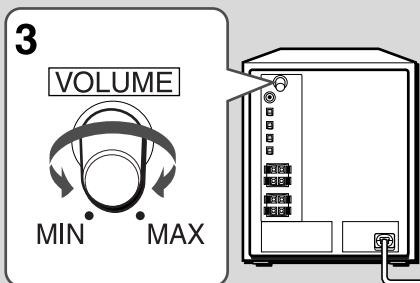
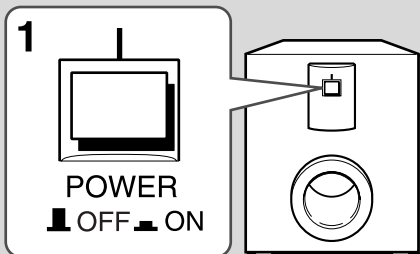

## Power and Volume

Adjust the volume balance between the powered subwoofer (TS-W150) and the left and right speakers of the connected equipment.

- 1 Press the POWER button.  
The indicator above the button lights up.
- 2 Start playback on the connected equipment.
- 3 Adjust the volume of the powered subwoofer.

### Moderate volume setting

To get natural bass sounds, adjust the volume of the powered subwoofer according to its position and the graphic equalizer setting of the connected equipment.

### Adjustment examples

- a Set the VOLUME control to a little lower than the middle when the subwoofer is **placed on the floor** and the graphic equalizer is set to off.
- b Set the VOLUME control to the middle when the subwoofer is **positioned higher than the floor** and the graphic equalizer is set to off.

### Notes

- To avoid overloading the powered subwoofer, do not set the volume of the connected equipment so high that the sound is distorted.
- Low frequency sounds may be distorted when they are emphasized by the graphic equalizer on the connected equipment. Adjust the VOLUME control on the powered subwoofer or the graphic equalizer on the connected equipment.
- If the powered subwoofer will not be used for a long period of time, press the POWER button to turn off the power, and unplug the AC cord from the wall outlet.

# SPECIFICATIONS

Input terminals	INPUT 1 jack INPUT 2 terminals
Input sensitivity/impedance	INPUT 1: 400 mV/10 kilo ohms (at 50 Hz) INPUT 2: 4 V/4.5 kilo ohms (L and R) (at 50 Hz)
Output terminals	SPEAKERS OUT terminals
Power output	150 W (4 ohms, T.H.D. less than 1%, at 50 Hz to 200 Hz) 180 W (4 ohms, T.H.D. 10%, at 100 Hz)
Frequency response	50 Hz – 200 Hz
Speaker type	Bass reflex type
Speaker unit	25 cm (9 7/8 in.) (Magnetically shielded type)
Power requirement	AC 120 V, 60 Hz
Power consumption	70 W
Dimensions (w/h/d)	320 × 378 × 447 mm ( 12 5/8 × 15 × 17 5/8 in.)
Weight	14.1 kg (31 lbs 1 oz.)

Specifications and external appearance are subject to change without notice.

## Phase

Depending upon the room or the characteristics of the right and left speakers, sound from the powered subwoofer may seem unnatural or unusually loud or soft.

In this case, try changing the PHASE switch setting. Set to the NORMAL or REVERSE position, whichever sounds better.

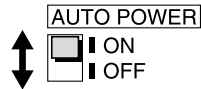
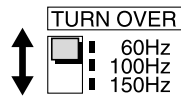

## BASS SOUND RANGE

*You can adjust the sound range of the powered subwoofer to complement the sound range of the other speakers.*

Set the TURN OVER switch to one of the three positions.

- 60 Hz: Output 60 Hz and under.
- 100 Hz: Output 100 Hz and under.
- 150 Hz: Output 150 Hz and under.

## AUTO POWER

Before using this function, make sure the POWER button is set to ON.

While the AUTO POWER switch is set to ON, the power is automatically turned on when receiving a signal input from either INPUT 1 or INPUT 2. The power is automatically turned off if no signal is input for a while and the indicator of the POWER button turns off.

If input signal is too weak (e.g. at a quiet scene in a DVD playback), this function may not work.

In such a case, set the AUTO POWER switch to OFF.

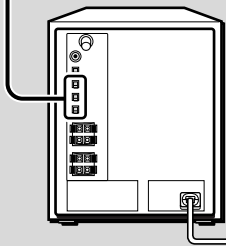

---

For assistance and information  
***call toll free 1-800-BUY-AIWA***  
(United States and Puerto Rico)

**AIWA CO.,LTD.**  
 <http://www.aiwa.co.jp>

Printed in China